

S P E C I A L   A G E N D A

BOARD OF RECREATION AND PARK COMMISSIONERS  
OF THE CITY OF LOS ANGELES

Wednesday, October 24, 2012 at 9:30 a.m.

Granada Hills Recreation Center (A.K.A. Petit Park)  
16730 Chatsworth Street  
Granada Hills, CA 91344

EVERY PERSON WISHING TO ADDRESS THE COMMISSION MUST COMPLETE A SPEAKER'S REQUEST FORM AT THE MEETING AND SUBMIT IT TO THE COMMISSION EXECUTIVE ASSISTANT PRIOR TO THE BOARD'S CONSIDERATION OF THE ITEM.

PURSUANT TO COMMISSION POLICY, COMMENTS BY THE PUBLIC ON AGENDA ITEMS WILL BE HEARD ONLY AT THE TIME THE RESPECTIVE ITEM IS CONSIDERED, FOR A CUMULATIVE TOTAL OF UP TO FIFTEEN (15) MINUTES FOR EACH ITEM. ALL REQUESTS TO ADDRESS THE BOARD ON PUBLIC HEARING ITEMS MUST BE SUBMITTED PRIOR TO THE BOARD'S CONSIDERATION OF THE ITEM. COMMENTS BY THE PUBLIC ON ALL OTHER MATTERS WITHIN THE SUBJECT MATTER JURISDICTION OF THE BOARD WILL BE HEARD DURING THE "PUBLIC COMMENTS" PERIOD OF THE MEETING. EACH SPEAKER WILL BE GRANTED TWO MINUTES, WITH FIFTEEN (15) MINUTES TOTAL ALLOWED FOR PUBLIC PRESENTATION.

1.    INTRODUCTIONS:

Special Introduction and Opening Remarks by Councilmember Mitchell Englander, Council District 12, or His Appointed Representative

Kevin Regan, Assistant General Manager, Recreation Operations, will Introduce the Staff of Granada Hills Recreation Center

2.    APPROVAL OF THE MINUTES:

Approval of the Minutes of the Meetings of October 3, 2012

3.    GENERAL MANAGER'S REPORTS:

12-286      Banning Museum - Phase III (PRJ2001) (W.O. #E170493F);  
Banning Park - Improvements to Athletic Fields,  
Recreation Center and Walking Paths (PRJ20242) (W.O.  
#E170364F); Elysian Park - Improvements to Athletic  
Fields and Trails, Road Refurbishment, Lighting and  
Restrooms (W.O. #E170199F) - Final Acceptance

12-287      Spring Street Park - Phase II (PRJ20387) (W.O.  
#E1907464) Project - Escrow Agreement for Security  
Deposits in Lieu of Retention

12-288      South Victoria Avenue Park - 6537 South Victoria Avenue  
- Acquisition and Acceptance of Donation Parcel

October 24, 2012

12-289 Jim Gilliam Child Care Center - California Department of Education 2013-14 General Child Care and Development and California State Preschool Programs - Authorization of Continued Funding Application for Subsidized Preschool Services; Acceptance of Grant Funds

12-290 Various Communications

4. UNFINISHED BUSINESS:

11-238 Sherman Village River Greenway Park - Preliminary **Item to be Continued** Authorization to Proceed with the Lease of Property Owned by the County of Los Angeles for the Development of a New Public Park and a Memorandum of Agreement between the Department of Recreation and Parks, the County of Los Angeles, and IMT Capital, LLC, for the Development and Maintenance of the New Public Park

12-212 Griffith Park Train Ride Concession - Proposed Ticket **Item to be Continued** Price Increase

Memorandum: L.A. Shares Contributions to Recreation and Parks **Item to be Continued**

5. NEW BUSINESS:

Memorandum: 2013 Meeting Schedule for the Board of Recreation and Park Commissioners

6. COMMISSION TASK FORCES:

- Commission Task Force on Concessions (Commissioners Stanley and Williams)
- Commission Task Force on Facility Repair and Maintenance (Commissioners Alvarez and Werner)

7. GENERAL MANAGER'S ORAL REPORT:

Report on Department Activities and Facilities

8. FUTURE AGENDA ITEMS:

Requests by Commissioners to Schedule Specific Items on Future Agendas

October 24, 2012

9. PUBLIC COMMENTS:

Any comments which require a response or report by staff will be automatically referred to staff for a report at some subsequent meeting.

10. NEXT MEETING:

The next scheduled meeting of the Board of Recreation and Park Commissioners will be held on Wednesday, November 7, 2012 at 9:30 a.m., at EXPO Center, Comrie Hall, 3980 S. Bill Robertson Lane (Formerly Menlo Avenue), Los Angeles, CA 90037.

11. ADJOURNMENT:

Under the California State Ralph M. Brown Act, those wishing to make audio recordings of the Commission Meetings are allowed to bring tape recorders or camcorders in the Meeting.

Sign language interpreters, assistive listening devices, or any auxiliary aides and/or services may be provided upon request. To ensure availability, you are advised to make your request at least 72 hours prior to the meeting you wish to attend. For additional information, please contact the Commission Office at (213)202-2640.

Finalization of Commission Actions: In accordance with City Charter, actions that are subject to Section 245 are not final until the expiration of the next five meeting days of the Los Angeles City Council during which the Council has convened in regular session and if Council asserts jurisdiction during this five meeting day period the Council has 21 calendar days thereafter in which to act on the matter.

Commission Meetings can be heard live over the telephone through the Council Phone system. To listen to a meeting, please call one of the following numbers:

from Downtown Los Angeles	(213) 621-CITY (2489)
from West Los Angeles	(310) 471-CITY (2489)
from San Pedro	(310) 547-CITY (2489)
from Van Nuys	(818) 904-9450

For information, please go to the City's website:  
<http://ita.lacity.org/Residents/CouncilPhone/index.htm>

The official electronic website posting location for the Agendas for the meetings of the Department of Recreation and Park Board of Commissioners and its Task Forces is at [WWW.LACITY.ORG](http://WWW.LACITY.ORG)

Information on agenda items may be obtained by calling the Commission Office at (213) 202-2640. Copies of the agenda and reports may be downloaded from the Department's website at [www.laparks.org](http://www.laparks.org).



REPORT OF GENERAL MANAGER

NO. 12-286

DATE October 24, 2012

C.D. 1 and 15

BOARD OF RECREATION AND PARK COMMISSIONERS

SUBJECT: BANNING MUSEUM – PHASE III (PRJ20001) (W.O. #E170493F); BANNING PARK – IMPROVEMENTS TO ATHLETIC FIELDS, RECREATION CENTER AND WALKING PATHS (PRJ20242) (W.O. #E170364F); ELYSIAN PARK – IMPROVEMENTS TO ATHLETIC FIELDS AND TRAILS, ROAD REFURBISHMENT, LIGHTING AND RESTROOMS (W.O. #E170199F) – FINAL ACCEPTANCE

R. Adams	_____	K. Regan	_____
H. Fujita	_____	*M. Shull	<u><i>MS</i></u>
V. Israel	_____	N. Williams	_____

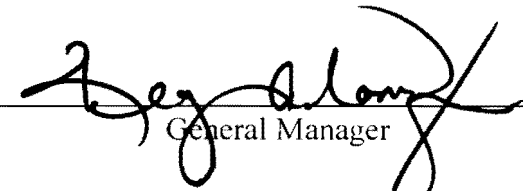
  
 \_\_\_\_\_  
 General Manager

Approved \_\_\_\_\_ Disapproved \_\_\_\_\_ Withdrawn \_\_\_\_\_

RECOMMENDATIONS:

That the Board:

1. Accept the work performed under the Memorandum of Understanding (MOU) between the Department of Recreation and Parks (RAP), the Bureau of Engineering (BOE), and the Department of General Services (GSD) for Banning Museum – Phase III (PRJ20001) (W.O. #E170493F), as outlined in the Summary of this Report;
2. Accept the work performed under the Memorandum of Understanding (MOU) between the Department of Recreation and Parks (RAP), the Bureau of Engineering (BOE), and the Department of General Services (GSD) for Banning Park – Improvements to Athletic Fields, Recreation Center and Walking Paths (PRJ20242) (W.O. #E170364F), as outlined in the Summary of this Report;
3. Accept the work performed under the Memorandum of Understanding (MOU) between the Department of Recreation and Parks (RAP), the Bureau of Engineering (BOE), and the Department of General Services (GSD) for Elysian Park – Improvements to Athletic Fields and Trails, Road Refurbishment, Lighting and Restrooms (W.O. E170199F), as outlined in the Summary of this Report; and,

REPORT OF GENERAL MANAGER

PG. 2                      NO. 12-286

4. Authorize the Board Secretary to furnish GSD with a letter of completion for each project.

SUMMARY:

During the Fiscal Years 2008-2009 through 2010-2011, the following three (3) construction projects were awarded to GSD through the approval of MOUs between the RAP, BOE, and GSD. The table below contains the final project information including the number of change orders, the cost of change orders, and the total construction costs.

Project Name	Banning Museum Phase III	Banning Park – Improvements to Athletic Fields, Recreation Center and Walking Paths	Elysian Park – Improvements to Athletic Fields and Trails, Road Refurbishment, Lighting and Restrooms
Address	401 East M Street, Wilmington, 90744	1331 Eubank Avenue, Wilmington, 90744	855 Academy Road, Los Angeles, 90012
RAP Project No.	PRJ20001	PRJ20242	N/A
BOE Work Order No.	E170493F	E170364F	E170199F
Project Description	Refurbishment of Buildings and Garden Improvements	Improvements to athletic fields, recreation center and walking paths	Improvements to Athletic Fields and Trails, Road Refurbishment, Lighting and Restrooms
Construction Completion Date	9/29/11	11/28/11	11/15/11
Change Orders	5	1	11
Total Change Order Amount	\$ 60,822	\$ 1,396	\$ 48,636
Total Construction Costs	\$ 309,537.49	\$ 249,163.39	\$ 564,450.48

## REPORT OF GENERAL MANAGER

PG. 3                      NO. 12-286

Construction of the three (3) projects was as follows:

1. Banning Museum Phase III (PRJ20001) (W.O. #E170493F). On May 5, 2010, construction was awarded to GSD through the approval of an MOU between RAP, BOE, and GSD (Board Report No. 10-102). The project was funded with Proposition K Funds. The community began using the facility on September 29, 2011.
2. Banning Park – Improvements to Athletic Fields, Recreation Center and Walking Paths (PRJ20242) (W.O. #E170364F). On May 21, 2008, construction was awarded to GSD through the approval of an MOU between RAP, BOE, and GSD (Board Report No. 08-134), a Supplemental Agreement was approved by the Board on November 15, 2010 (Board Report No. 10-317). The project was funded with Quimby and Proposition K funds. The community began using the facility on November 28, 2011. This project was completed at \$23,380 under GSD's original cost estimate.
3. Elysian Park – Improvements to Athletic Fields and Trails, Road Refurbishment, Lighting and Restrooms (W.O. #E170199F). On June 2, 2010, construction was awarded to GSD through the approval of an MOU between RAP, BOE, and GSD (Board Report No. 10-138). The project was funded with Proposition K funds. The community began using the facility on October 15, 2011.

GSD has finished the work, and the Bureau of Engineering's Construction Management Division completed the construction management of these three projects. BOE has advised RAP that GSD completed the construction of these three projects and that the quality of the work is excellent.

There were no contract compliance or labor issues with the work done under these MOUs. Some of the construction work was completed by City employees and other work by subcontractors under the supervision of GSD staff.

### FISCAL IMPACT STATEMENT:

Banning Museum – Phase III: For this facility, there is no fiscal impact to RAP's General Fund. Current staff will continue to provide the necessary maintenance. The improvements will be assets to this facility.

Banning Park – Improvements to Athletic Fields, Recreation Center and Walking Paths: For this facility, there is no fiscal impact to RAP's General Fund. Current staff will continue to provide the necessary maintenance. The improvements will be assets to this facility.

Elysian Park – Improvements to Athletic Fields and Trails, Road Refurbishment, Lighting and Restrooms: For this facility, there is no fiscal impact to RAP's General Fund. Current staff will continue to provide the necessary maintenance. The improvements will be assets to this facility.

REPORT OF GENERAL MANAGER

PG. 4            NO. 12-286

This report was prepared by William Tseng and Shashi Bhakta, Project Managers, Recreational and Cultural Facilities Program, BOE. Reviewed by Neil Drucker, Program Manager, Recreational and Cultural Facilities Program, BOE; Deborah Weintraub, Chief Deputy City Engineer, BOE; and by Michael A. Shull, Superintendent, Planning, Construction and Maintenance Branch, Department of Recreation and Parks.



REPORT OF GENERAL MANAGER

NO. 12-287

DATE October 24, 2012

C.D. 14

BOARD OF RECREATION AND PARK COMMISSIONERS

SUBJECT: SPRING STREET PARK – PHASE II (PRJ20387) (W.O. #E1907464) PROJECT  
— ESCROW AGREEMENT FOR SECURITY DEPOSITS IN LIEU OF  
RETENTION

R. Adams \_\_\_\_\_  
H. Fujita \_\_\_\_\_  
V. Israel \_\_\_\_\_

K. Regan \_\_\_\_\_  
•M. Shull mf  
N. Williams \_\_\_\_\_

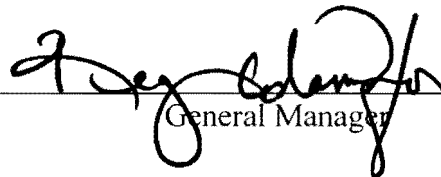
  
\_\_\_\_\_  
General Manager

Approved \_\_\_\_\_

Disapproved \_\_\_\_\_

Withdrawn \_\_\_\_\_

RECOMMENDATIONS:

That the Board:

1. Approve the request of Environmental Construction, Inc. (Contractor), Contract No. 3376, to enter into an Escrow Agreement, substantially in the form on file in the Board of Recreation and Park Commissioners' (Board) Office, with the City of Los Angeles for Security Deposits in Lieu of Retention for the Spring Street Park – Phase II (PRJ20387) (W.O. #E1907464) project;
2. Direct the Board Secretary to transmit the Escrow Agreement to the City Attorney for review and approval as to form; and,
3. Authorize the Board President and Board Secretary to execute said Escrow Agreement upon approval as to form by the City Attorney.

SUMMARY:

The Department of Recreation and Parks (RAP) is in receipt of a request from the Contractor, Contract No. 3376, for the Spring Street park – Phase II (PRJ20387) (W.O. #E1907464) project, to enter into an Escrow Agreement for Security Deposits in Lieu of Retention.

## REPORT OF GENERAL MANAGER

PG. 2                      NO. 12-287

Pursuant to Section 22300 of the Public Contract Code of the State of California, the Contractor has the option to deposit securities with an Escrow Agent as a substitute for retention earnings required to be withheld by the City as Owner, pursuant to the Construction Contract entered for the Spring Street Park – Phase II (PRJ20387) (W.O. #E1907464) project in the amount of \$1,380,777, dated June 20, 2012. Alternatively, on written request of the Contractor, the City can make payments of the retention earnings directly to the Escrow Agent.

When the City makes payment of retentions earned directly to the Escrow Agent, the Escrow Agent shall hold them for the benefit of the Contractor until such time as the escrow created under the contract is terminated. The Contractor may direct the investment of the payments into securities. All terms and conditions of the Escrow Agreement and the rights and responsibilities of the parties shall be equally applicable and binding when the City pays the Escrow Agent directly.

### FISCAL IMPACT STATEMENT:

There is no fiscal impact on the Department's General Fund.

This report was prepared by LaTonya D. Dean, Commission Executive Assistant.

REPORT OF GENERAL MANAGER

NO. 12-288

DATE October 24, 2012

C.D. 8

BOARD OF RECREATION AND PARK COMMISSIONERS

SUBJECT: SOUTH VICTORIA AVENUE PARK – 6537 SOUTH VICTORIA AVENUE –  
ACQUISITION AND ACCEPTANCE OF DONATION PARCEL

R. Adams \_\_\_\_\_  
H. Fujita \_\_\_\_\_  
V. Israel \_\_\_\_\_

K. Regan \_\_\_\_\_  
\*M. Shull *ms*  
N. Williams \_\_\_\_\_

*[Signature]*  
General Manager

Approved \_\_\_\_\_

Disapproved \_\_\_\_\_

Withdrawn \_\_\_\_\_

RECOMMENDATIONS:

That the Board:

1. Adopt a Resolution, substantially in the form on file in the Board of Recreation and Park Commissioners' (Board) Office, authorizing staff to request the assistance of the Department of General Services (GSD) and other entities, and per Charter Section 594 (a) and (b), to accept on behalf of the City of Los Angeles, a donation from the Trust for Public Land (TPL) via grant deed from TPL's seller of the 0.26 acres or 11,357 square feet vacant parcel (Assessor's Parcel Number (APN) 4006-019-014), see the attached Assessor's Map labeled as Exhibit A;
2. Upon the completion of the preliminary acquisition activities, and satisfactory findings of all due diligence work including Title review and Phase I and any necessary environmental investigations, direct staff to proceed with processing escrow instructions and related documents to accept the donation property;
3. Authorize the Board Secretary to execute the escrow instructions and accept the grant deed, subject to approval as to form by the City Attorney, for the Subject Property identified by APN 4006-019-014 directly from seller or TPL, which property shall be set apart and dedicated as park property in perpetuity; and,

## REPORT OF GENERAL MANAGER

PG. 2

NO. 12-288

4. Authorize and request that GSD assist in the acquisition and to process the conveyance of the property located at 6537 South Victoria Avenue, Los Angeles the donated parcel identified by APN 4006-019-014 to the Department of Recreation and Parks (RAP) on behalf of the City of Los Angeles.

### SUMMARY:

On July 19, 2012, the Board approved Board Report No. 12-224 granting preliminary approval of the acquisition, development and construction of a new park (South Victoria Avenue Park) in the City of Los Angeles (City) as part of the Proposition 84 State Wide Park Program to develop new parks. Prior to the above action, the Board has taken several actions relating to the Proposition 84 State Wide Park Program.

On May 17, 2010 the Board approved a donation agreement between TPL and RAP for the acquisition, development and construction of new parks (Board Report No. 10-121). On August 17, 2010, City Council approved the agreement between TPL and RAP for the acquisitions, development and construction of new parks detailed in the July 23, 2010 City Administrative Officer (CAO) report in connection with the acquisition of four prospective parks, Council File No. 09-2839.

The goal was for TPL to acquire four (4) prospective parcels and to transfer them to RAP for park purposes as part of the Statewide Proposition 84 program. On March 14, 2012, the Board approved an amendment to the agreement between TPL and RAP that would add three (3) new parks to the list (Board Report No. 12-066). The "South Victoria Avenue Park" project was one (1) of those three (3) parks. On August 8, 2012, per recommendation from the CAO, the Board approved a revised amendment (Board Report No. 12-237). The revised amendment removed one (1) park from the list but did not affect the South Victoria Park acquisition, development or construction project. The revised amendment remains substantially the same as the amendment that was approved by the Board on March 14, 2012. On September 18, 2012, the City Council adopted the revised amendment to the donation agreement which adds the South Victoria site to the list of TPL park projects, Council File No. 12-1406.

As it relates to the South Victoria Park acquisition project, the proposed new park site will serve a part of the inner City that lacks sufficient park space for families. The area is a densely populated low income area. This proposed park acquisition will address the City's park needs requirements, and goals which are addressed in the Citywide Community Needs Assessment (Needs Assessment). The 2009 Needs Assessment was prepared to identify the City's greatest park needs. The park acquisition is also an integral part of the Mayor's 50 Parks Initiative which would enable the City to meet and provide a small neighborhood park in a densely populated area of the City that lacks adequate access to park and recreational facilities. The goal of the Mayor's 50 Parks Initiative is to substantially increase the number of parks in the city, with the

## REPORT OF GENERAL MANAGER

PG. 3

NO. 12-288

specific focus on densely populated neighborhoods and communities that lack sufficient open space and recreational services.

### TPL Park Development

The proposed acquisition site is a vacant residential lot approximately 0.26 acre or 11,357 square feet. The site is located at 6537 South Victoria Avenue in the West Adams-Baldwin Hills-Leimert Community Plan area of the City of Los Angeles. TPL will acquire, design and develop the site into a park for RAP. The proposed park design features will include: a skate spot area, trees and shade structures, children's playground equipment, a junior sized basketball court area, adult fitness equipment and safety features such as a decorative fence and gate and night-sky friendly lighting. The park will also feature screen planting along the perimeter of the park boundary and a mosaic seat wall. The park will be landscaped with drought tolerant plants. Completion of the park is scheduled for 2019. See the attached design plan labeled as Exhibit B. TPL has allocated One Million Seven Hundred Ninety-Nine Thousand, One Hundred Thirty Dollars (\$1,799,130) for development of the park. Per the Donation Agreement executed on September 1, 2010 between TPL and RAP, TPL will submit plans and specifications for approval by the Board. RAP staff will issue to TPL a Right-of-Entry Permit (ROE) for the development of the Park. TPL will use Proposition 84 Statewide Park Program funds for the development of the Park.

### Funding

On March 26, 2012, TPL received information from the California State Parks (State) that it had been awarded funding under the second round of Proposition 84 Statewide Park Program for the South Victoria Avenue Park project. The State awarded TPL a total of Two Million Two Hundred Thirty-Six Thousand, Six Hundred Thirty Dollars (\$2,236,630) in grant funding for the acquisition and development of this project. As per the Donation Agreement between TPL and RAP, TPL will acquire the site and transfer said property to RAP upon acquisition. Thereafter, RAP will issue a ROE so that TPL can develop the site into a park.

### Acquisition

RAP staff is requesting that the Board authorize the acceptance of approximately 0.26 acre or 11,357 square feet of vacant land that will be developed into a new park by TPL in a densely populated area of South Los Angeles. The proposed acquisition project consists of one parcel identified by APN 4006-019-014. The parcel is located at 6537 South Victoria Avenue between Hyde Park Boulevard to the north and 67th Street to the South in the South Los Angeles area of the City of Los Angeles (the Subject Property). The proposed acquisition will add greatly needed open space/recreation area to the South Los Angeles area. This acquisition is a rare opportunity to continue the progress in acquiring urban parkland in this portion of Los Angeles

## REPORT OF GENERAL MANAGER

PG. 4

NO. 12-288

which TPL, RAP and the City continue to work on together. The acquisition will bring more recreational resources to the entire city through expanded availability of recreational activities and facilities.

On April 27, 2012, an appraisal was prepared by Buss-Shelger Associates, Real Estate Consultants with an estimated "as is" fair market value of Two Hundred Sixty-Five Thousand Dollars (\$265,000). Enterprise Home Ownership Partners, Inc., a California nonprofit public benefit corporation (the Seller), has agreed to sell at the Fair Market Value. TPL has entered into an Option Agreement (Option) with Seller to acquire the property and pursuant to the terms of the Option, to pay the Seller the Fair Market Value. All funds needed under the Option for TPL to acquire the property for the Fair Market Value will be paid into escrow in cash or cash equivalents by the State of California at least one day prior to the Close of Escrow to allow TPL to exercise its Option. Pursuant to the terms of the option, TPL will donate the property to the City by directing Seller to convey title to the Property by deed directly to City pursuant to the terms of the Option Agreement.

TPL entered into an Option Agreement with the Seller of the property on February 9, 2012. TPL will exercise their Option and use State funds to acquire the property and donate the property to the City by directing the Seller to convey the property via grant deed directly to the City. GSD will ensure that City receives the property for the City and transfer jurisdiction and control to RAP. Upon acceptance of the conveyance and donation, RAP will set apart and dedicate the property as park property in perpetuity.

The Sellers of the above-mentioned property and TPL have agreed to a final purchase price of Two Hundred Sixty-Five Thousand Dollars (\$265,000). RAP, GSD, and TPL will review all related acquisition documents as part of their due diligence prior to closing escrow.

Staff has determined that the subject project will consist of the acquisition of land to preserve open space, and development of a new park with accessory structures including a new playground, junior-sized basketball court, skate spot, entry plaza, fitness equipment, shade structures, screen plantings, site furnishings, decorative fencing, irrigation, lighting and landscaping. Therefore, the project is exempt from the provisions of the California Environmental Quality Act (CEQA) pursuant to Article 111, Section 1, Class 3(6), and Class 4 (1, 3) of the City CEQA Guidelines, and Article 19, Section 15325, Class 25(f) of the State CEQA guidelines. A Notice of Determination was filed with the Los Angeles County Clerk on August 13, 2012.

In addition to the Office of Council District 8, the Assistant General Manager of Branch Operations concurs with staff's recommendations.

REPORT OF GENERAL MANAGER

PG. 5

NO. 12-288

FISCAL IMPACT STATEMENT:

All cost for the acquisition and development of this parcel will be incurred by TPL and will have no impact on the Department's General Fund. Approximately Twenty-Five Thousand Dollars (\$25,000) a year will be requested to maintain this facility. This amount will cover the cost for staffing, materials and supplies. This will also provide at least four (4) hours of maintenance per day, seven (7) days a week, year round. If the funding is not granted, this facility will be included in the existing Pacific Region routes resulting in a reduction of core functions on existing routes.

This report was prepared by John Barraza, Management Analyst II, Real Estate and Asset Management Section, Planning, Construction and Maintenance Division.





4006 | 19 | 1996  
 SCALE 1" = 80'

REVISED  
 1-26-60.  
 3-8-60  
 880321-88  
 951211

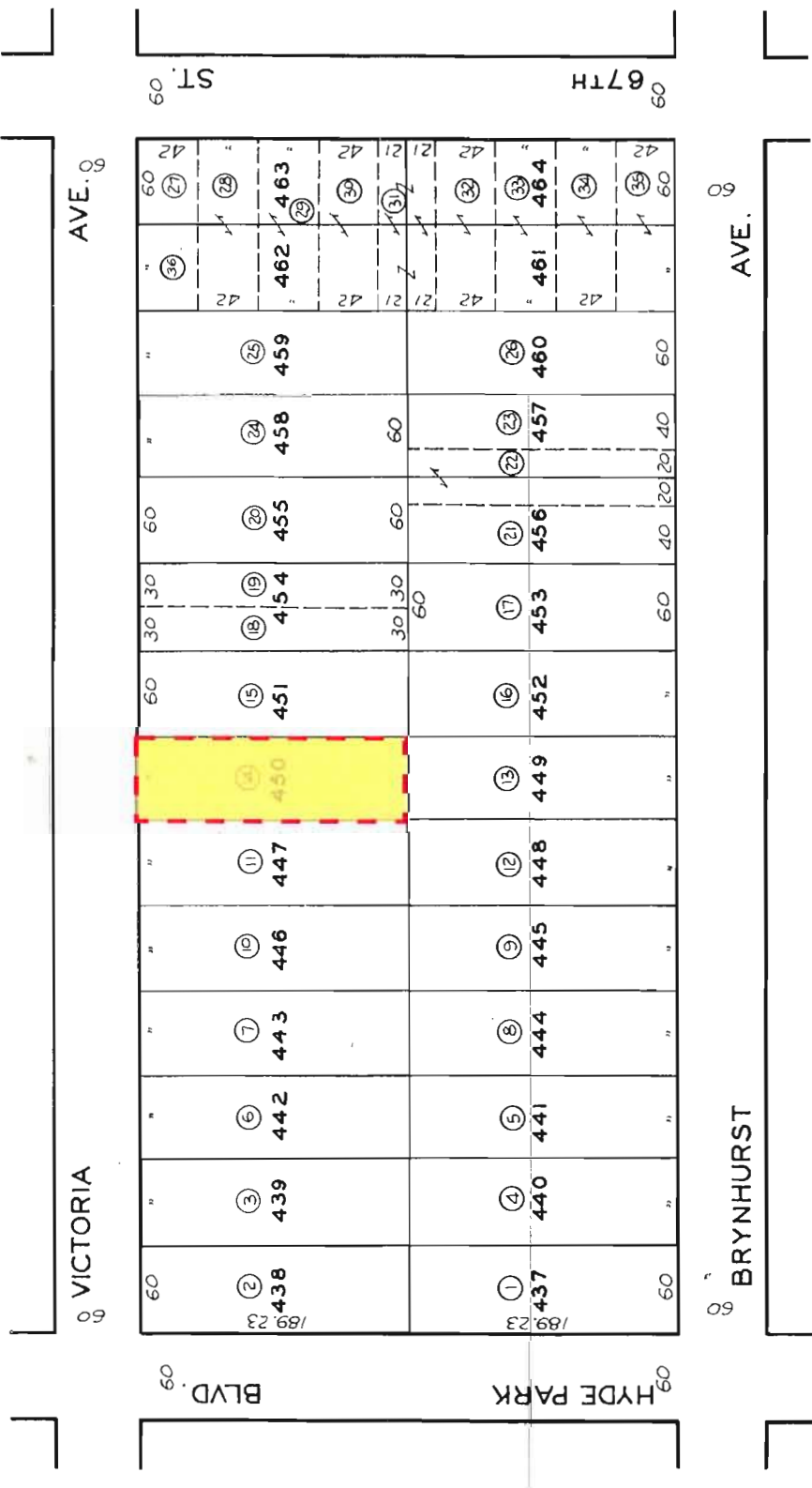

SUPPLEMENTAL MAP OF HYDE PARK

M. R. 34-9



CODE  
6612

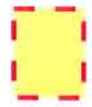

PROJECT SITE

FOR PREV. ASSM'T. SEE: 1582 - 19

Exhibit A

ASSESSOR'S MAP  
 COUNTY OF LOS ANGELES, CALIF.

S. Victoria Ave



North  
June 2011



**South Victoria Avenue Park Concept Design**  
 The Trust for Public Land ~ City of Los Angeles Recreation and Parks  
 Statewide Park Development and Community Revitalization Program Application

REPORT OF GENERAL MANAGER

NO. 12-289

DATE October 24, 2012

C.D. 10

BOARD OF RECREATION AND PARK COMMISSIONERS

SUBJECT: JIM GILLIAM CHILD CARE CENTER – CALIFORNIA DEPARTMENT OF EDUCATION 2013-14 GENERAL CHILD CARE AND DEVELOPMENT AND CALIFORNIA STATE PRESCHOOL PROGRAMS – AUTHORIZATION OF CONTINUED FUNDING APPLICATION FOR SUBSIDIZED PRESCHOOL SERVICES; ACCEPTANCE OF GRANT FUNDS

R. Adams		K. Regan	_____
H. Fujita	_____	M. Shull	_____
*V. Israel	_____	N. Williams	_____

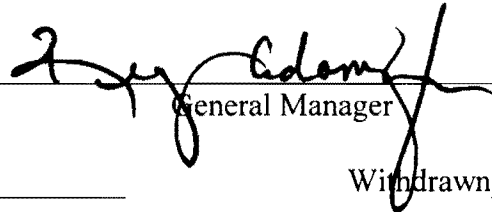
  
 \_\_\_\_\_  
 General Manager

Approved \_\_\_\_\_

Disapproved \_\_\_\_\_

Withdrawn \_\_\_\_\_

RECOMMENDATIONS:

That the Board:

1. Authorize the Department of Recreation and Parks (Department) to submit a continued funding application for the 2013-14 General Child Care Program (CCTR) in an amount up to \$10,000 and the 2013-14 California State Preschool Program (CSPP) in an amount up to \$200,000 to the California Department of Education (CDE) for subsidized preschool services at the Jim Gilliam Child Care Center, subject to Mayor and City Council consideration;
2. Direct staff to transmit a copy of the grant application to the Mayor, Office of the City Administrative Officer (CAO), Office of the Chief Legislative Analyst (CLA) and to the City Clerk for committee and City Council approval before accepting and receiving the grant awards, pursuant to the Administrative Code Section 14.6 et seq. as may be amended;
3. Authorize the Department’s General Manager to accept and receive the 2013-14 CCTR continued funding, if awarded, in an amount up to \$10,000 and the 2013-14 CSPP continued funding award, if awarded, in an amount up to \$200,000 from the CDE for subsidized preschool services at the Jim Gilliam Child Care Center, subject to the approval of the Mayor and City Council;

## REPORT OF GENERAL MANAGER

PG. 2      NO. 12-289

4. Designate the Department's General Manager, Executive Officer, or Assistant General Manager, as the agent to conduct all negotiations, execute and submit all documents, including, but not limited to applications, agreements, amendments, and payment requests and so on, which may be necessary; and
5. Authorize the Department's Chief Accounting Employee to establish the necessary accounts within "Recreation and Parks Grant" Fund 205 to accept the 2013-14 CCTR continued funding, if awarded, in an amount up to \$10,000 and the 2013-14 CSPP funding, if awarded, in an amount up to \$200,000 for subsidized preschool services at Jim Gilliam Child Care Center.

### SUMMARY:

The California Department of Education (CDE) is offering existing contractors the opportunity to request continued funding for fiscal year 2013-14 for Child Care and Development programming. The Department is a current recipient of General Child Care Program (CCTR) and California State Preschool Program (CSPP) funding. The funding provides subsidized preschool services at the Jim Gilliam Child Care Center for eligible children ages three to five years old.

Since January of 1986, the Department has received CDE funds to operate the child care services at the Jim Gilliam Child Care Center. The program is the Department's first licensed pre-school program and serves children of families with incomes at or below the 75 percent State median income level. The center is licensed by the State to serve 45 children from three to five years of age and is currently operating at full capacity. The subsidized program at the Jim Gilliam Child Care Center makes it possible for children to remain at the center for the full day.

Preschool programming helps children develop academic, cognitive, and behavioral skills that have proven to increase their chances for future success. This program also gives parents, who would otherwise be unable to afford preschool program services, the opportunity to seek employment or return to school to create better economic opportunities for their families.

The application is due in December 2012, and awards are typically announced once the State's budget is approved for that fiscal year.

### FISCAL IMPACT STATEMENT:

The CCTR and CSPP grants do not require a match, and thus presents no fiscal impact to the Department's General Fund. The grants assist the Department by providing additional funding to continue the subsidized preschool program at the Jim Gilliam Child Care Center.

This report was prepared by Kai Wong, Management Analyst II, Grants Administration.

REPORT OF GENERAL MANAGER

NO. 12-290

DATE October 24, 2012

C.D. Various

BOARD OF RECREATION AND PARK COMMISSIONERS

SUBJECT: VARIOUS COMMUNICATIONS

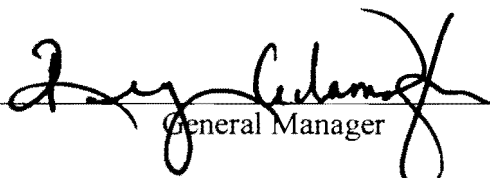
  
General Manager

Approved \_\_\_\_\_

Disapproved \_\_\_\_\_

Withdrawn \_\_\_\_\_

---

The following communications have been received by the Board and recommended action thereon is presented.

From:

Recommendation:

1) Councilmember Parks, forwarding a communication from Gloria Zuurveen relative to an incident at Tregnan Golf Academy.

Refer to General Manager.

2) City Clerk, relative to the 2011 Housing-Related Parks Program Grant.

Refer to General Manager.

3) City Clerk, relative to acceptance of Habitat Conservation Fund grant from the State of California for the White Point Park Nature Preserve.

Refer to General Manager.

4) City Clerk, relative to the allocation of Proposition K Program funds to offset a funding shortfall for the Sheldon Arleta Park Development project.

Note and File.

REPORT OF GENERAL MANAGER

PG. 2

NO. 12-290

- 5) City Clerk, relative to the re-appointment of Lynn Alvarez to the Board of Recreation and Park Commissioners. Note and File.
- 6) Chief Legislative Analyst, forwarding the Legislative Report for the weeks ending September 7, and September 14, 2012. Note and File.
- 7) Tracy Brooks and Andy Quioco, Quioco Concrete, Inc., relative to allegedly illegal actions of Nile Advanced Construction, Inc. on the Culver Slauson Recreation Center (W.O. #E1907289). Refer to General Manager.
- 8) Maureen Cassidy, to Councilmembers Reyes and Garcetti, relative to the fees for Montecillo De Leo Politi Park. Refer to General Manager.
- 9) Rick Selan, three communications relative to Oakwood Recreation Center. Note and File.
- 10) Deborah Everett, two communications relative to the lawsuit Michael Hunt v. City of Los Angeles. Note and File.
- 11) Kathy Lee, relative to the workers at an event at North Hollywood Recreation Center. Refer to General Manager.
- 12) Two Communicants, relative to the Hansen Dam Golf Pro Shop Concessionaire, Johns Wells. Refer to General Manager.
- 13) Bill Mouzis, relative to the Balboa Music Festival, with two replies from Carvel Bass, U.S. Army Corps Of Engineers. Refer to General Manager.

REPORT OF GENERAL MANAGER

PG. 3

NO. 12-290

14) Barbara Reed, relative to arranging transportation for her sick mother.

Refer to General Manager.

15) Mark Pineda, Field Auditor/Collector, Carpenters Southwest Administrative Corporation, relative to pension benefits allegedly owed to Carpenter Bryan C. Kelly.

Refer to General Manager.

16) George Zadrozny, GeoCon Skateparks, relative to California Skateparks and to the On-Call Skate Park/Skate Plaza Design Build list.

Refer to General Manager.

This report was prepared by Paul Liles, Clerk Typist, Commission Office.





FOR INFORMATION ONLY

CITY OF LOS ANGELES  
DEPARTMENT OF RECREATION AND PARKS

October 24, 2012

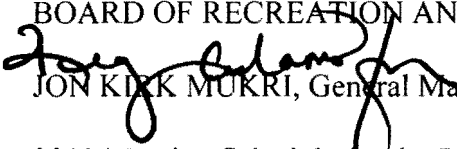
TO: BOARD OF RECREATION AND PARK COMMISSIONERS  
FROM:  JON KIRK MUKRI, General Manager  
SUBJECT: 2013 Meeting Schedule for the Board of Recreation and Park Commissioners

The Board of Recreation and Park Commissioners holds two meetings each month, generally on the first and third Wednesdays of the month, with the exception of July, August and December, when there is only one meeting, on the second Wednesday.

The majority of the meetings are at 9:30 A.M. at the EXPO Center, Comrie Hall, 3980 S. Bill Robertson Lane (formerly Menlo Avenue), Los Angeles, CA 90037. The remaining meetings are held at 9:30 A.M. at various recreational facilities throughout the City.

<u>DATE</u>	<u>LOCATION</u>	<u>TIME</u>
January 2, 2013	EXPO Center	9:30 am
<b>January 16, 2013</b>	<b>Pacific Region</b>	9:30 am
February 6, 2013	EXPO Center	9:30 am
<b>February 20, 2013</b>	<b>Valley Region</b>	9:30 am
March 6, 2013	EXPO Center	9:30 am
<b>March 20, 2013</b>	<b>Metro Region</b>	9:30 am
April 3, 2013	EXPO Center	9:30 am
<b>April 17, 2013</b>	<b>Pacific Region</b>	9:30 am
May 1, 2013	EXPO Center	9:30 am
<b>May 13, 2013</b>	<b>Valley Region</b>	9:30 am
<i>N.B. The second meeting in May is moved to Monday</i>		
June 5, 2013	EXPO Center	9:30 am
<b>June 19, 2013</b>	<b>Metro Region</b>	9:30 am
July 10, 2013	EXPO Center	9:30 am
<b>August 14, 2013</b>	<b>Pacific Region</b>	9:30 am
September 4, 2013	EXPO Center	9:30 am
<b>September 18, 2013</b>	<b>Valley Region</b>	9:30 am
October 2, 2013	EXPO Center	9:30 am
<b>October 16, 2013</b>	<b>Metro Region</b>	9:30 am
November 6, 2013	EXPO Center	9:30 am
<b>November 20, 2013</b>	<b>Pacific Region</b>	9:30 am
December 11, 2013	EXPO Center	9:30 am

This report was prepared by Paul Liles, Clerk Typist, Commission Office.



MATTERS PENDING

Matters Pending will be carried for a maximum of six months, after which time they will be deemed withdrawn and rescheduled whenever a new staff report is received.

GENERAL MANAGER'S REPORTS:

ORIGINALLY	PLACED	
PLACED ON	ON MATTERS	DEEMED
<u>BOARD AGENDA</u>	<u>PENDING</u>	<u>WITHDRAWN</u>

None

BIDS TO BE RECEIVED:

10/30/12	Mid-Valley Intergenerational Multipurpose Center (W.O. #E170239F)
11/13/12	St. Andrews Recreation Center - Outdoor Sports Development (W.O. #E170302F)

PROPOSALS TO BE RECEIVED:

10/23/12	Electrical Maintenance and Repairs of Outdoor Fields Lighting, Facilities and Solar Power Systems
10/23/12	Electrical Construction and Retrofit of Outdoor Fields Lighting, Facilities and Solar Power Systems
TBD	Film Production Instruction (CLASS Parks)